

Order #XXXXX - ECO-1072 - 10'x10' Sustainable Exhibit

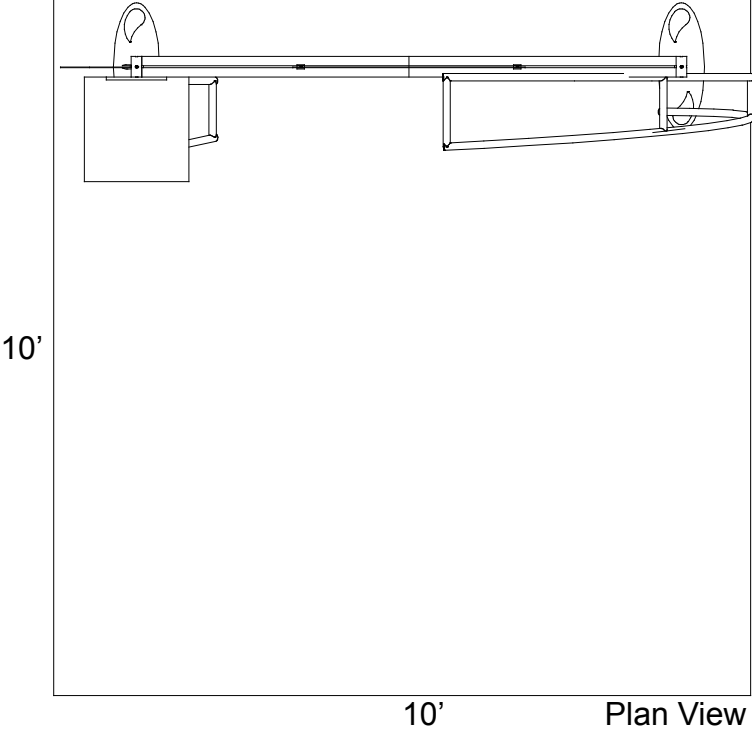
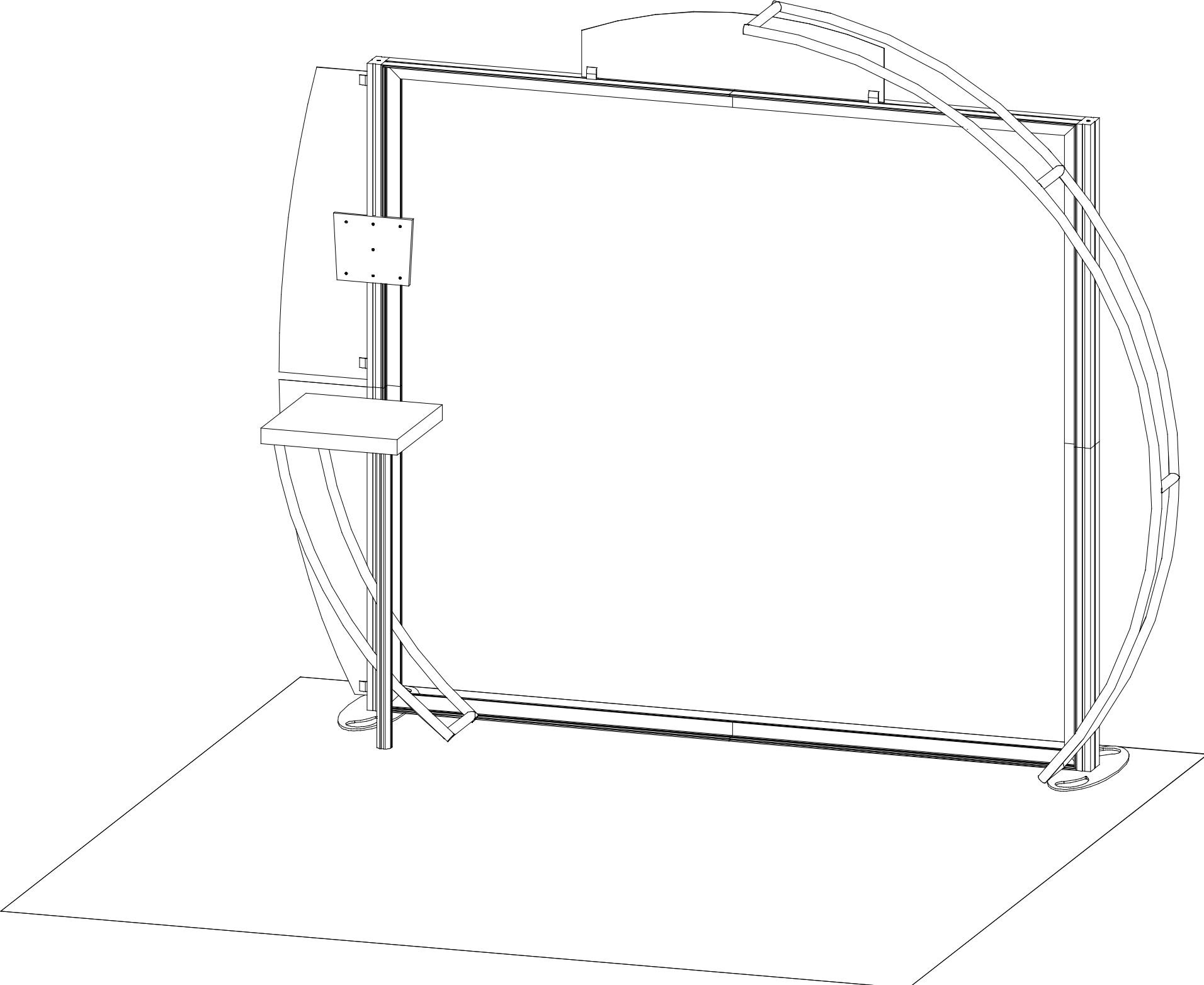

Setups

General Setup Instructions

- The setup instructions are created specifically for your configuration.
- Setup instructions are laid out sequentially in levels, including exploded views and a logical series of steps for assembly. We encourage you to study the instructions before attempting to assemble your exhibit.

Cleaning and Packing

- Use non-abrasive cleaners when cleaning extrusions or ECO Glass inserts.
- Use mild cleaners and soft materials such as cotton to clean all laminates.
- Keep exhibit components away from extreme heat and long exposure to sun light. This will prevent warping and fading.
- Retain all packing material for ease of re-packing. This protects the exhibit components and keeps each part organized.

Disassembling

- When disassembling exhibit, tighten all setscrews to prevent loss of hardware in the shipping process.

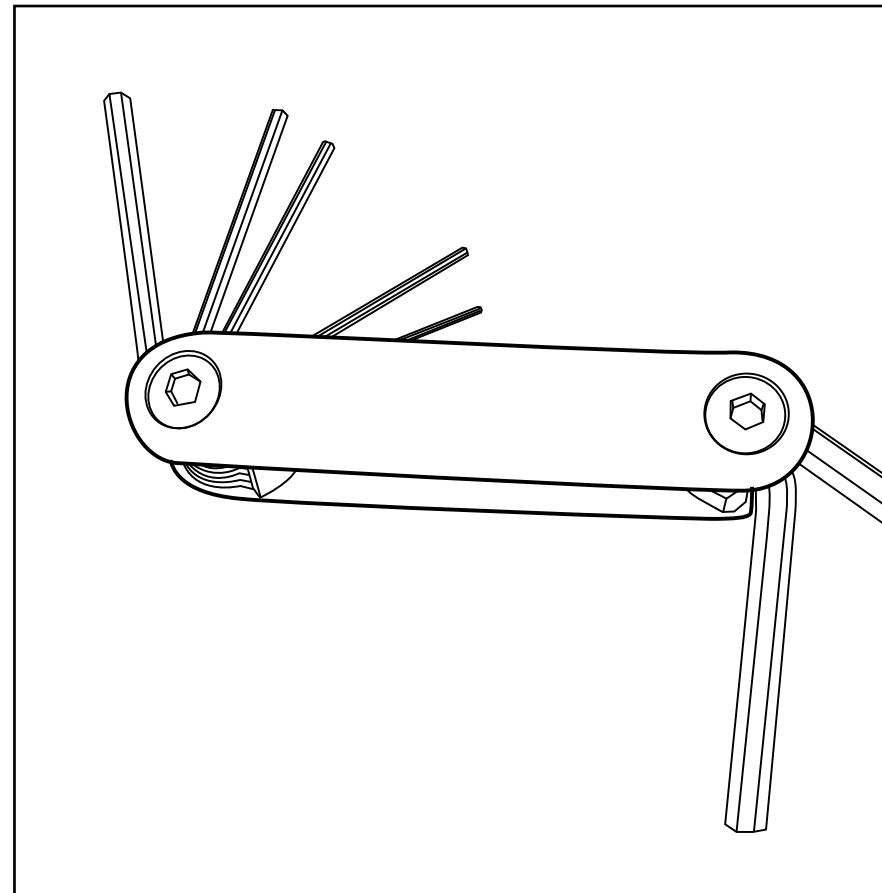

Hex Tool for Assembling Exhibit

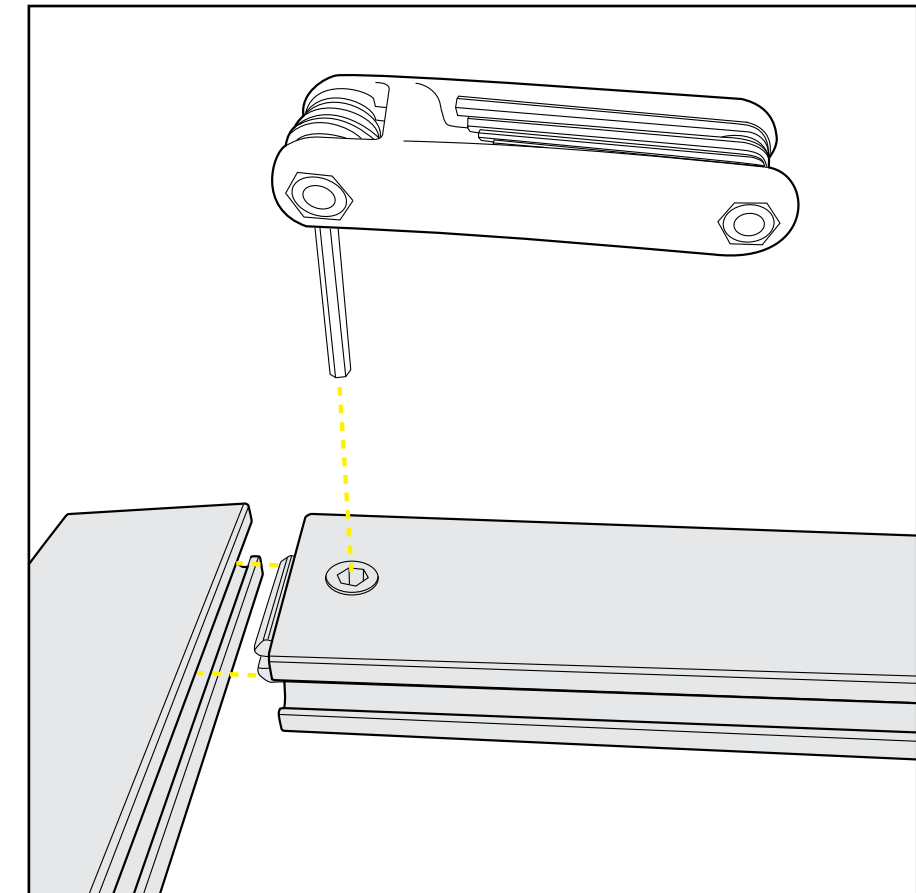

Extrusion Lock Connectors

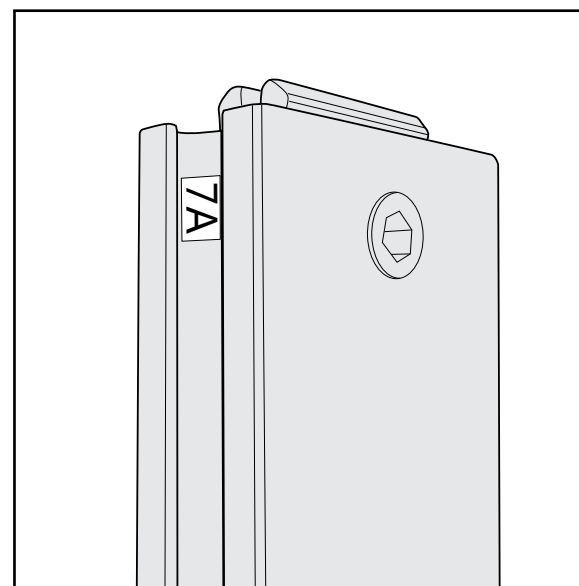

Numbering Instructions for Setups/Packing

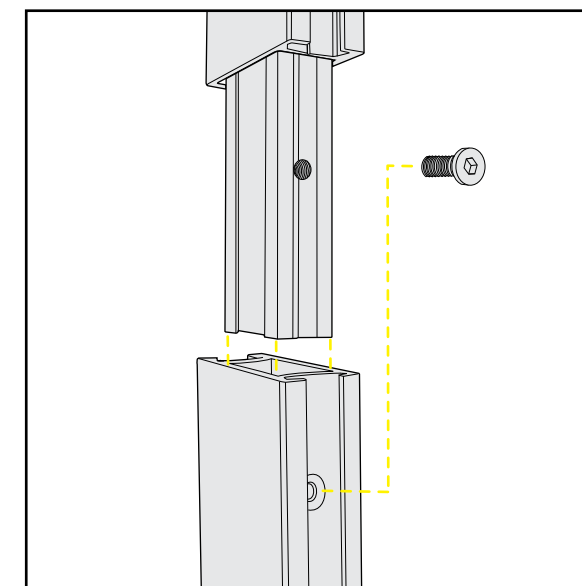

Inline Connection between Extrusions

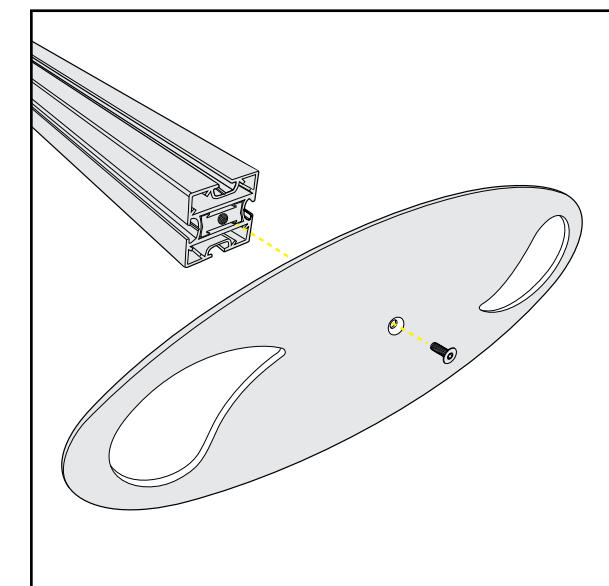

Baseplate Connection for Vertical Extrusions

ECO Panel Install

- 1 Place ECO panel together with a vertical offset, slide down to lock connector in place.
- 2 Panel Corner Connectors are installed just like ECO panels. Remove by off-setting top lock clips horizontally followed by separating vertically.

SEG Graphic Install

- 1 Graphic is installed corners first. This allows a proportional fit around the perimeter of the extrusion.
- 2 Locate channels along the edge of the extrusions.
- 3 Fold over graphic (hiding threads) and tuck silicon edge and fabric into corners.
- 4 After corners are complete, slide in the rest of the graphic into channel. (From edges to center)
- 5 Graphic is installed. Stand back and be amazed!

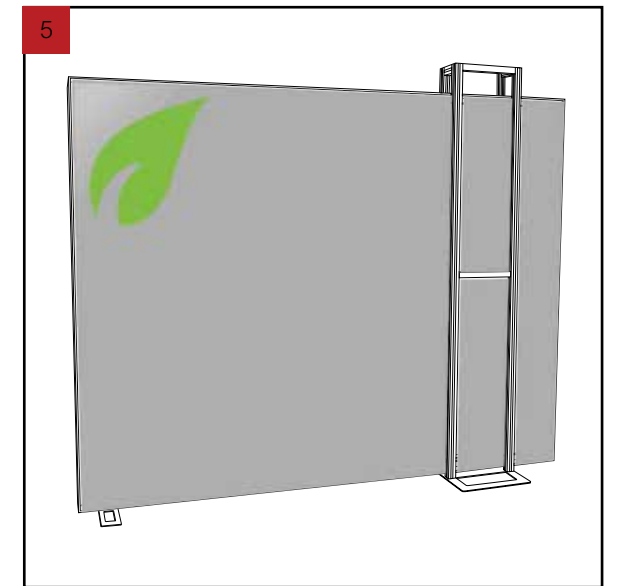
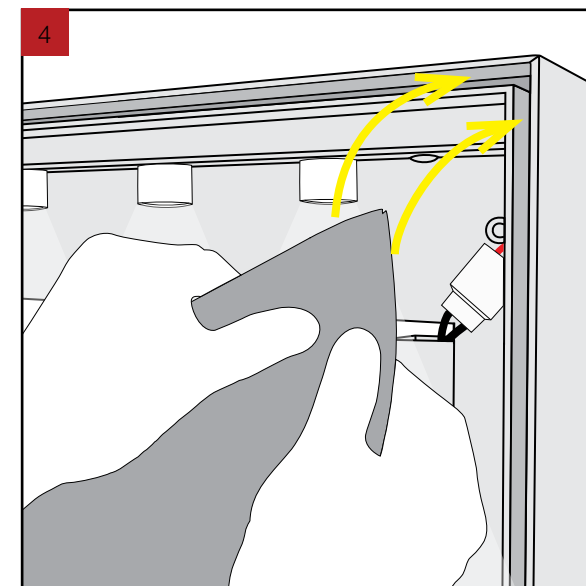
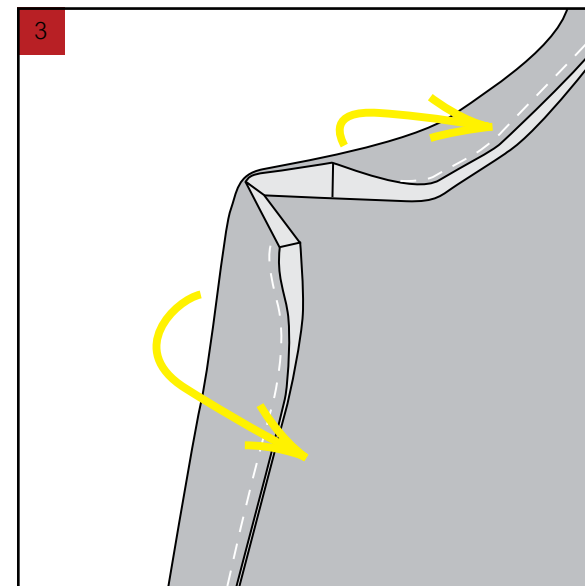
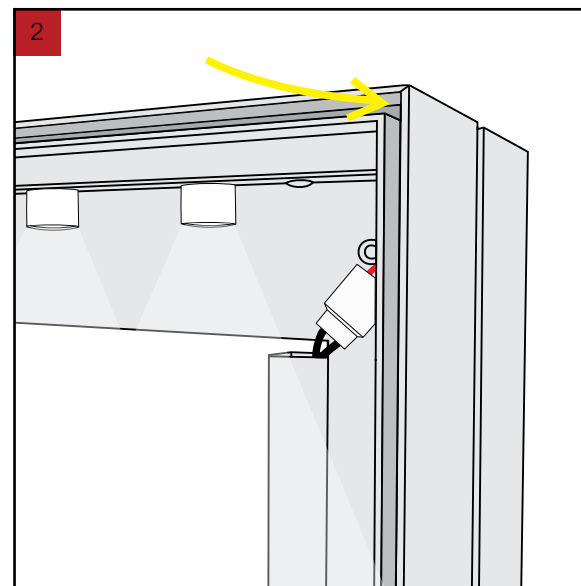
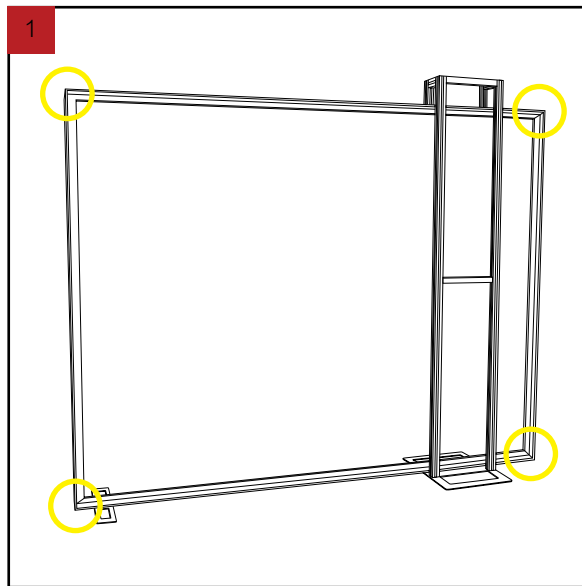
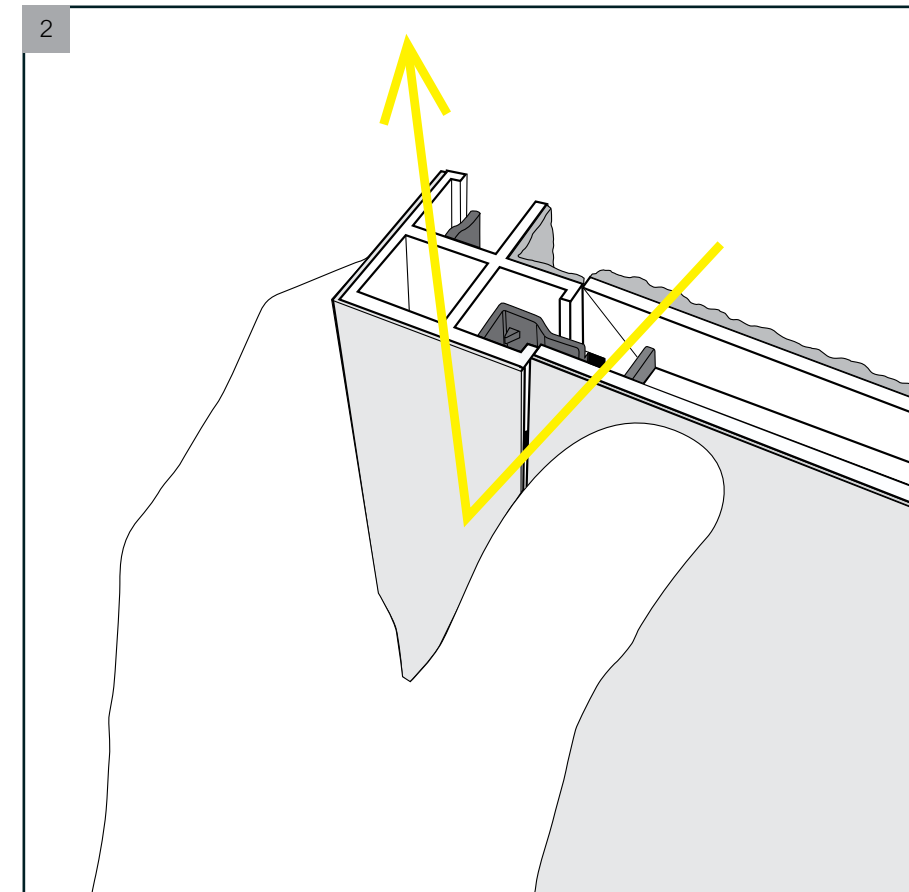
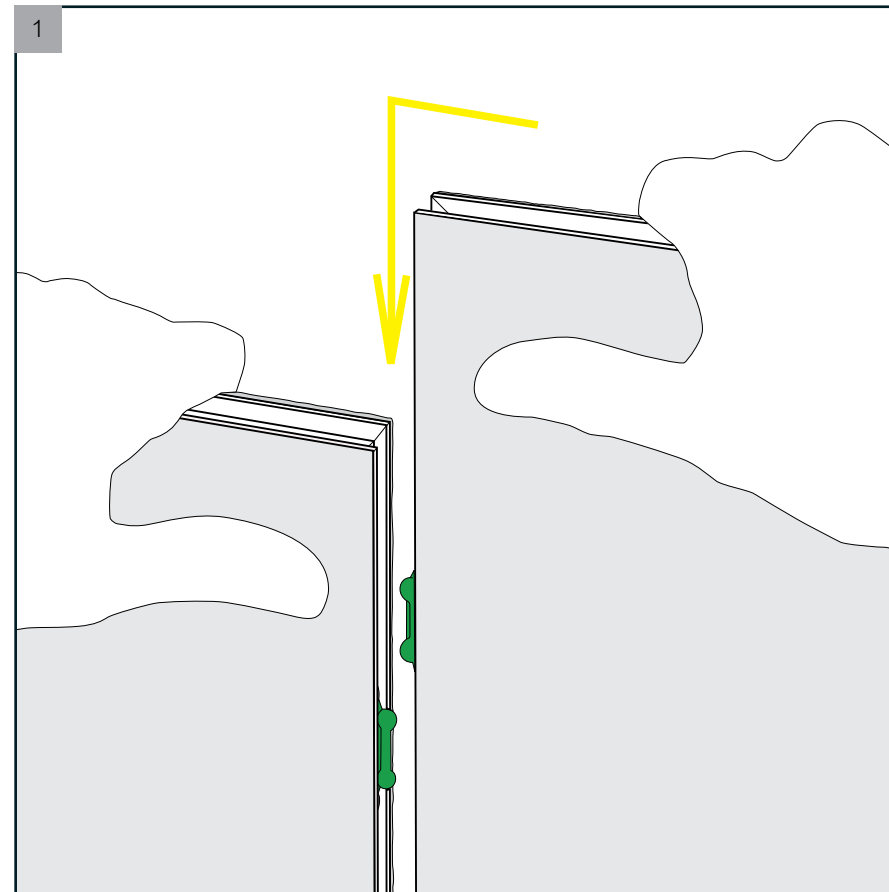

Top View of Each Level

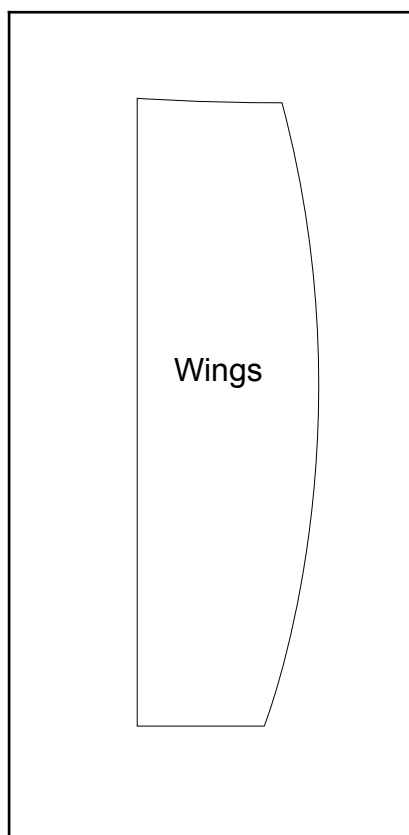

Level 1

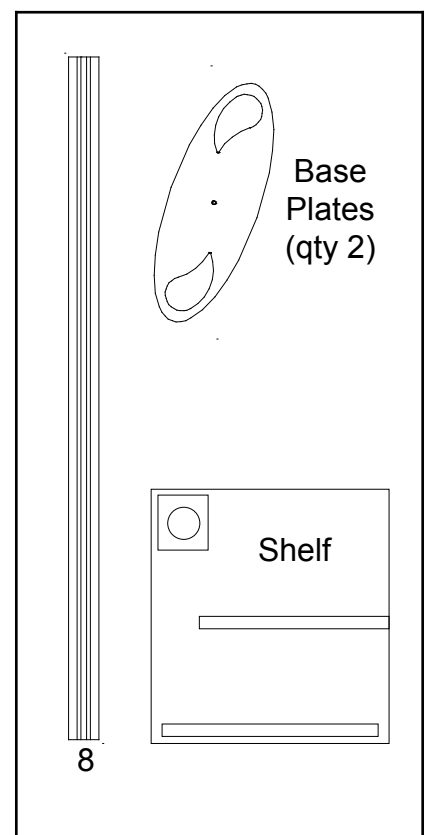

Level 2

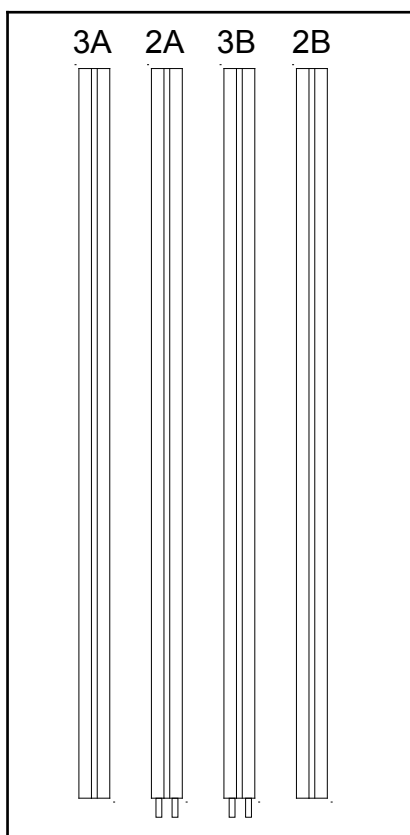

Level 3

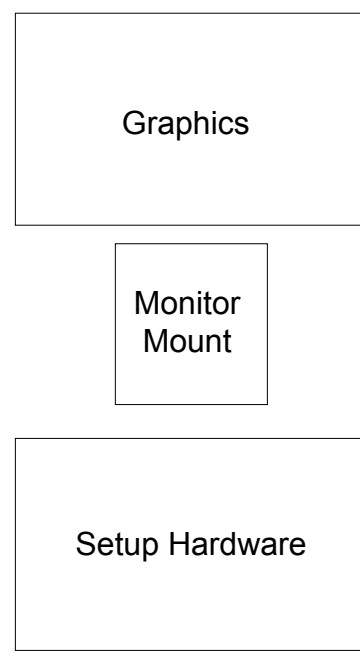

Top View of Each Level

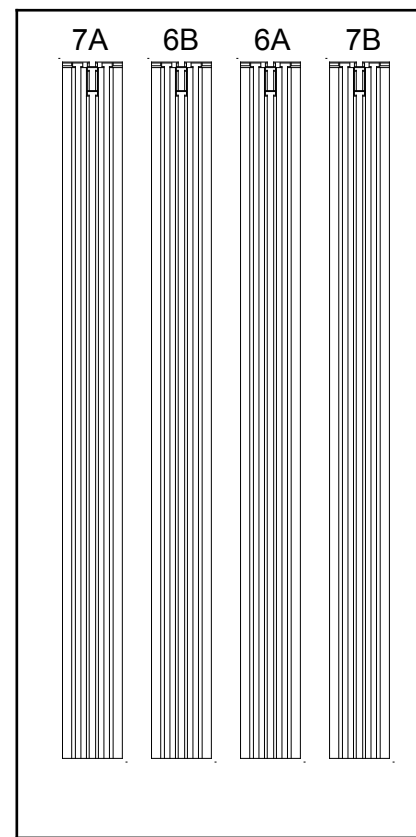

Level 1

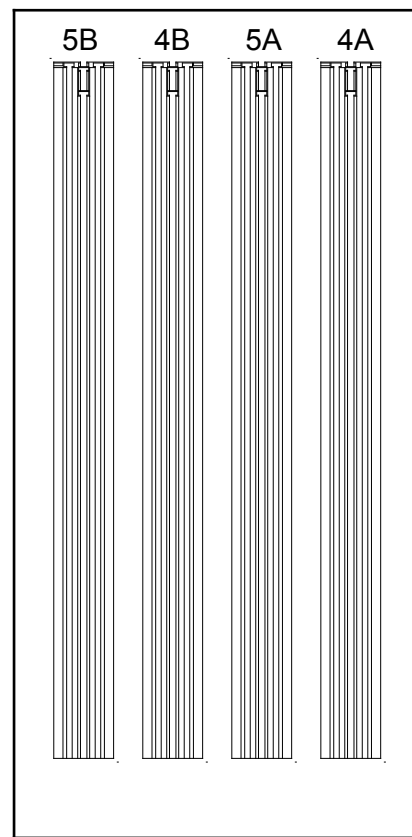

Level 2

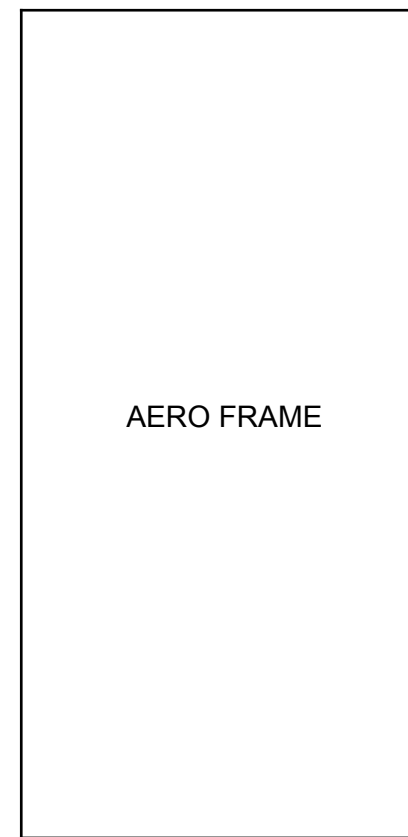

Level 3

| Item | Qty. | Description |
|-------|------|--------------------------------|
| 1 | 2 | Baseplates |
| 2A/2B | 1/1 | 42" S91 Vertical Extrusion |
| 3A/3B | 1/1 | 42" S91 Vertical Extrusion |
| 4A/4B | 1/1 | 46" TSP50 Horizontal Extrusion |
| 5A/5B | 1/1 | 46" TSP50 Horizontal Extrusion |
| 6A/6B | 1/1 | 42" TSP50 Vertical Extrusion |
| 7A/7B | 1/1 | 42" TSP50 Vertical Extrusion |

- Steps:
- 1) Connect Base Plates [1] to Verticals [2A,3A].
 - 2) Connect Verticals [2A-2B], [3A-3B].
 - 3) Connect Horizontals [4A-5A] & [4B-5B].
 - 4) Connect Verticals [6A-7A] & [6B-7B].
 - 5) Connect Horizontal and Vertical assemblies [4A-5A], [4B-5B], [6A-7A], [6B-7B] together at corners. See [Corner Connection](#) detail.
 - 6) Connect Vertical assemblies [2A-2B] & [3A-3B] to Verticals of assembled frame [6A-7A], [6B-7B]. See [Custom Cam Lock](#) detail.

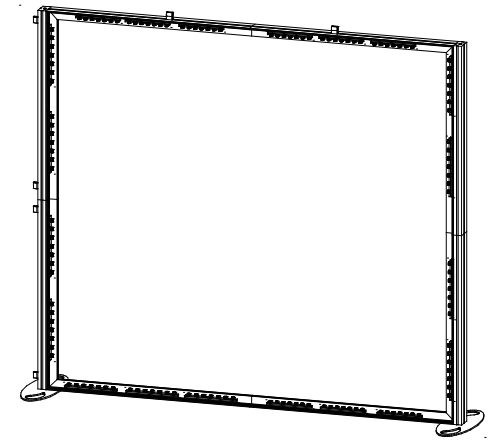

Step 1

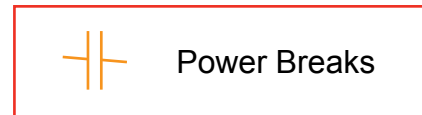
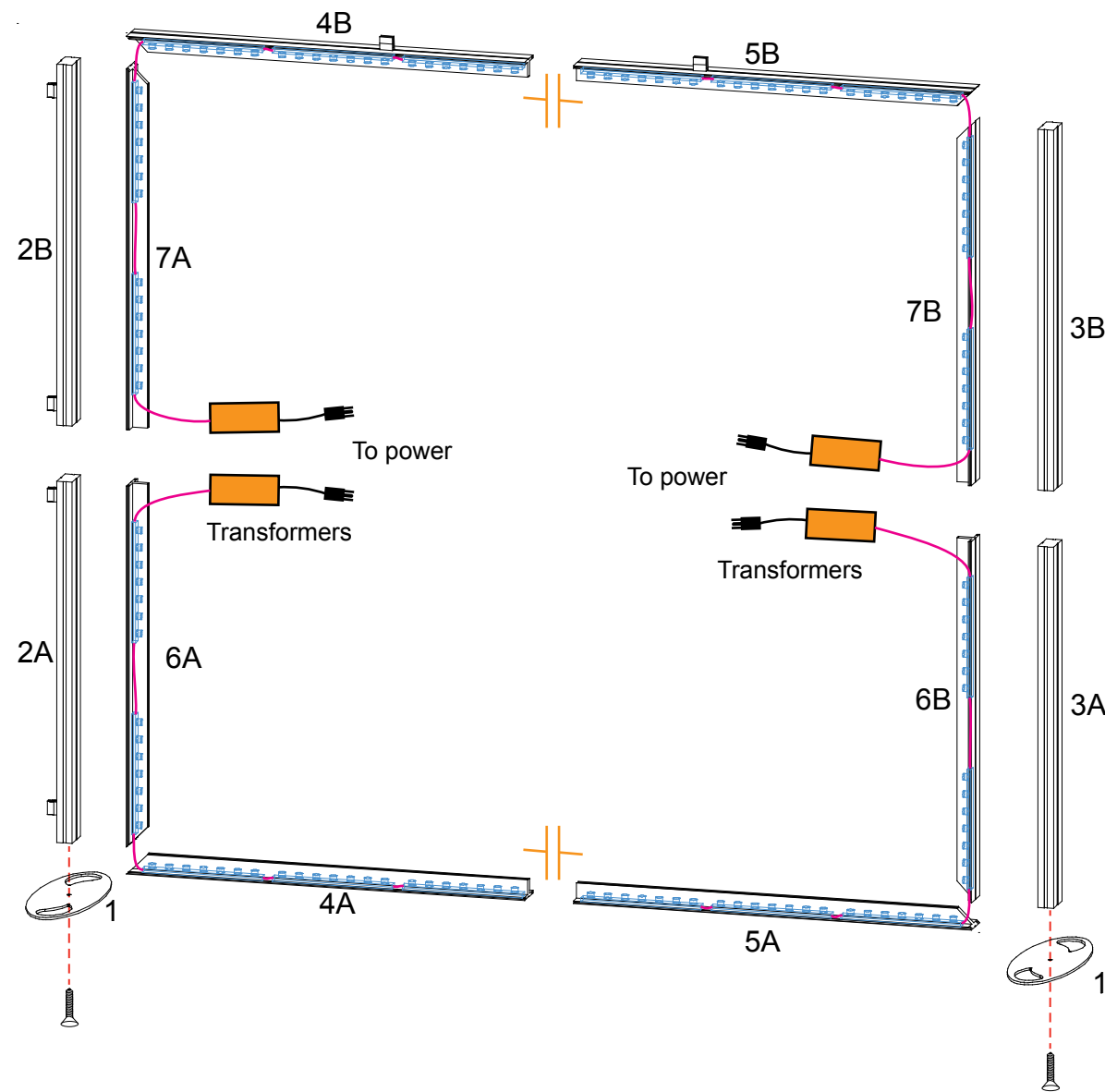

When assembled

Light to Light Attachment

Light to Transformer Attachment

Maximum of 7 lights per chain, 9 lights per Transformer

Installation Warning

If utilizing your own hardware, purchase **nylon washers** to prevent metal screw heads from damaging the circuit board. Attach no more than **seven** lights per chain.

Bolt, Nylon Washer, Diamond Washer

*** Corner Connection**

Lock, TSP50

Tighten setscrew to secure extrusions

*** Custom Cam Lock**

Top View, Cam Lock, TSP50

Screw clamps cam lock into groove of vertical extrusion.

Steps:
1) Connect Wings, Header Graphic, and Monitor Mount to frame.

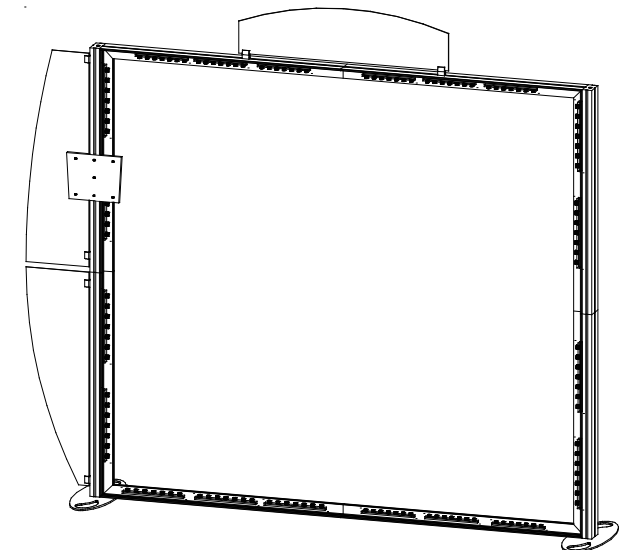
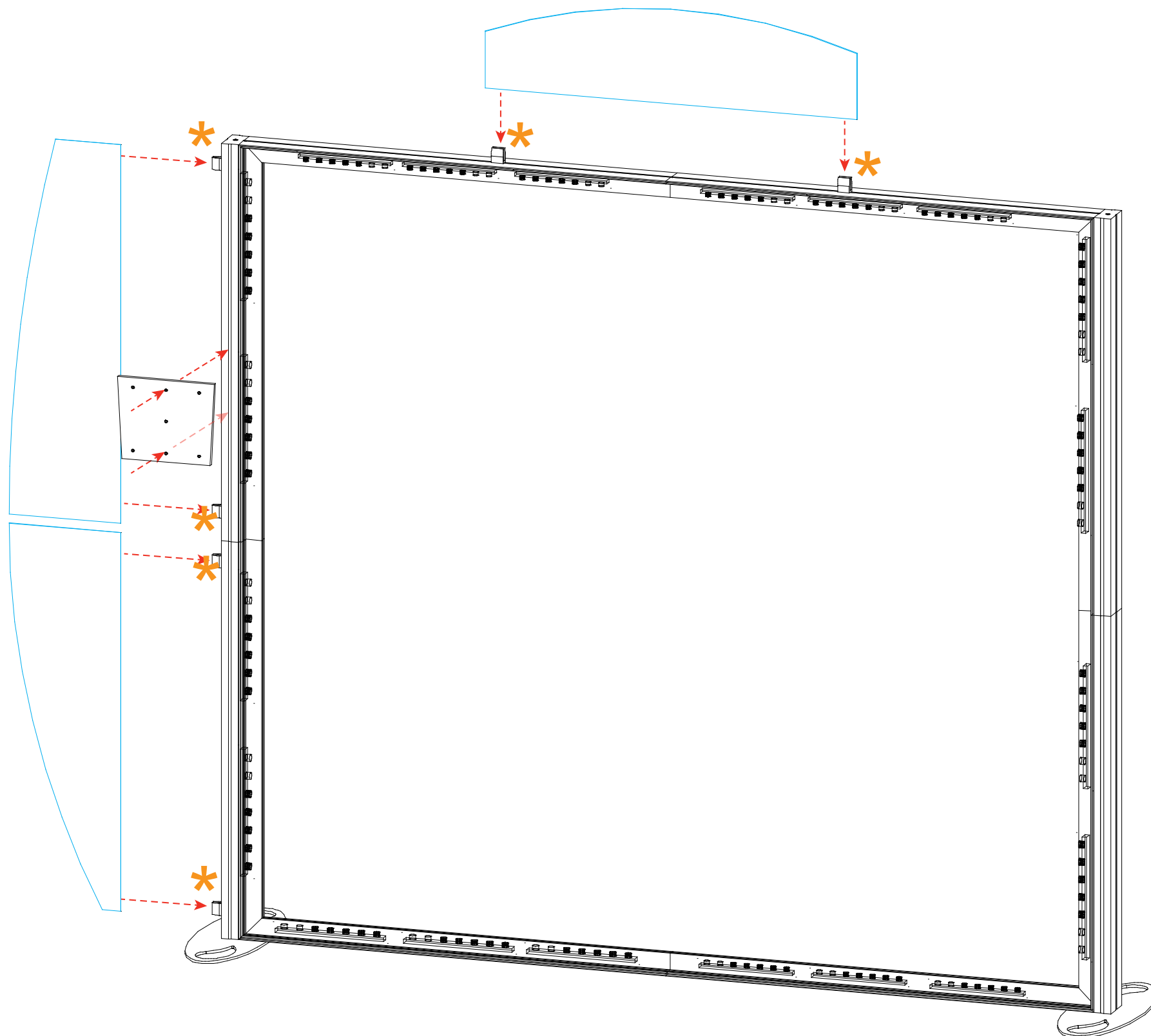

When assembled

* Monitor Mount Attachment

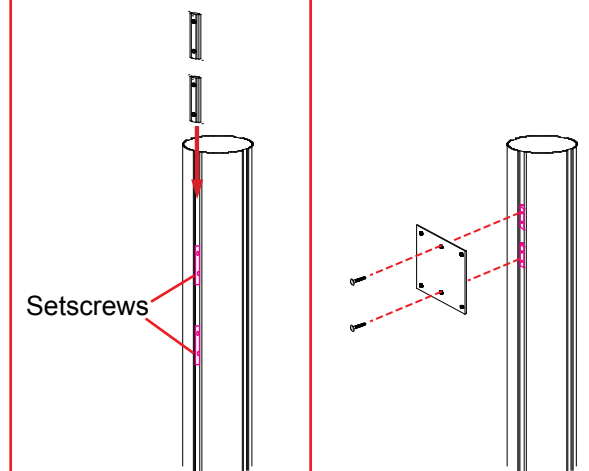

Slide connectors into groove of extrusion. Tighten setscrew to secure in place.

Attach back plate to connectors using screws. Attach top plate and tighten setscrews to secure.

* A10 Clamp Detail

- 1) Slide A10 connector into groove of extrusion.
- 2) Tighten set screw to secure A10 to extrusion.
- 3) Insert Infill into Clamp
- 4) Tighten knob to secure wing in place.

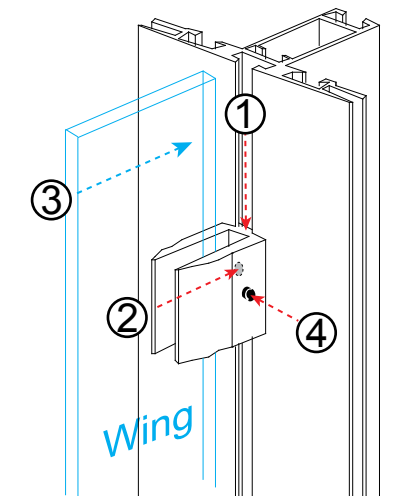

AERO

Steps:
1) Connect Aero Frame pieces in alphabetical order.

Using Your Setup Instructions

The Aero Overhead Sign Setup Instructions are created specifically for your configuration. They include an exploded view of the frame which is sequentially numbered. We encourage you to study the instructions before attempting to assemble your exhibit.

Connections are kept very simple: no tools. Everything assembles with push-button connectors and pre-connected horizontal sections.

Cleaning and Packing Your Display

- 1) Use care when cleaning aluminum extrusion or acrylic inserts. Use only non-abrasive cleaners.
- 2) Retain all packing material. It will make re-packing much easier and will reduce the likelihood of shipping damage.

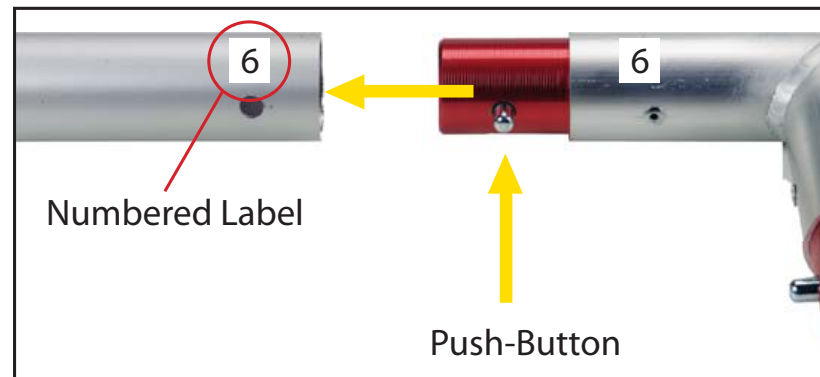

Connections are made by holding the button down and sliding the red tube into opposing tube until the connection is made. To disassemble push button and pull or twist extrusions apart.

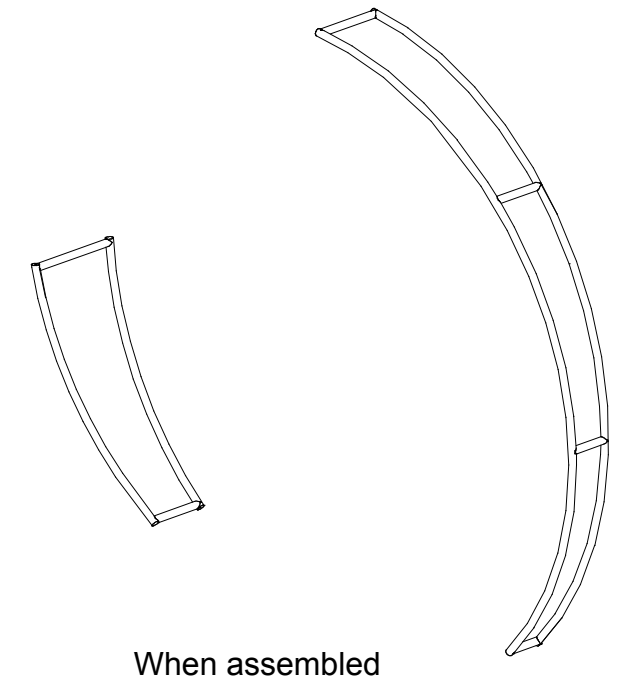
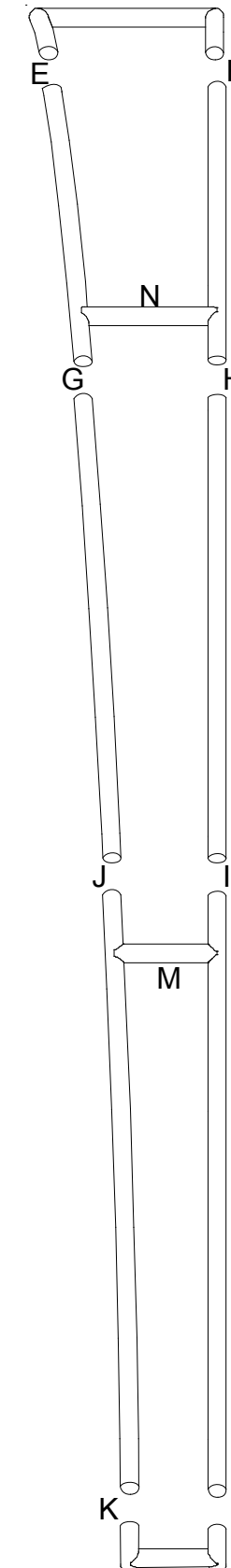
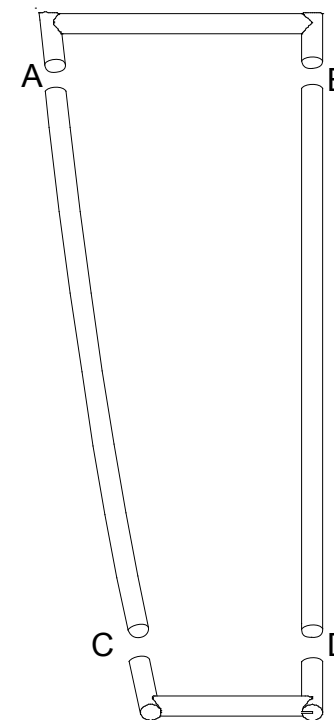
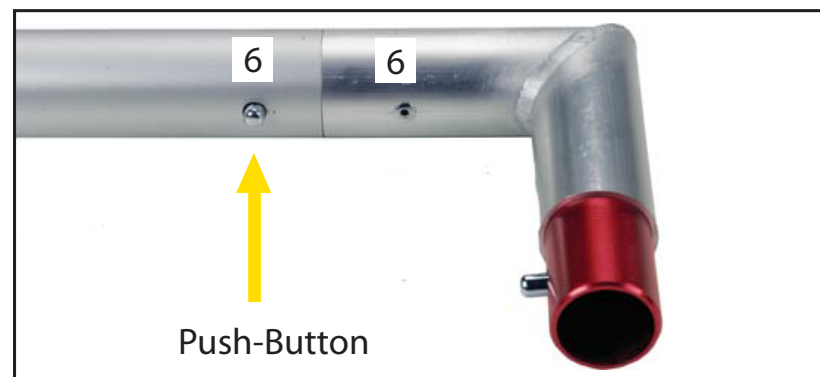

Step 3

| Item | Qty. | Description |
|------|------|-------------------------------|
| 8 | 1 | 40" RSG540 Vertical Extrusion |

Steps:
1) Connect Aero frames, counter support extrusion, & Countertop.

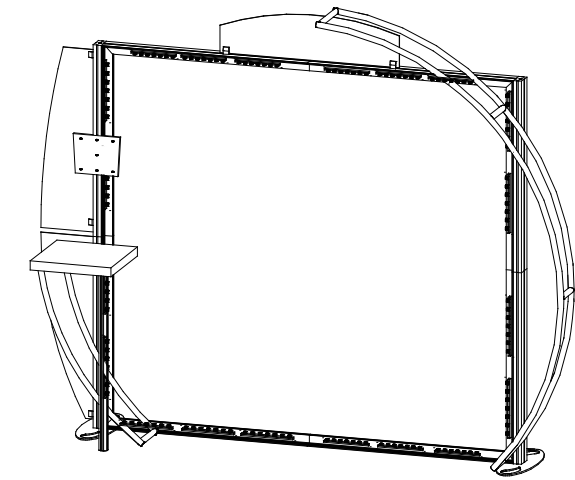
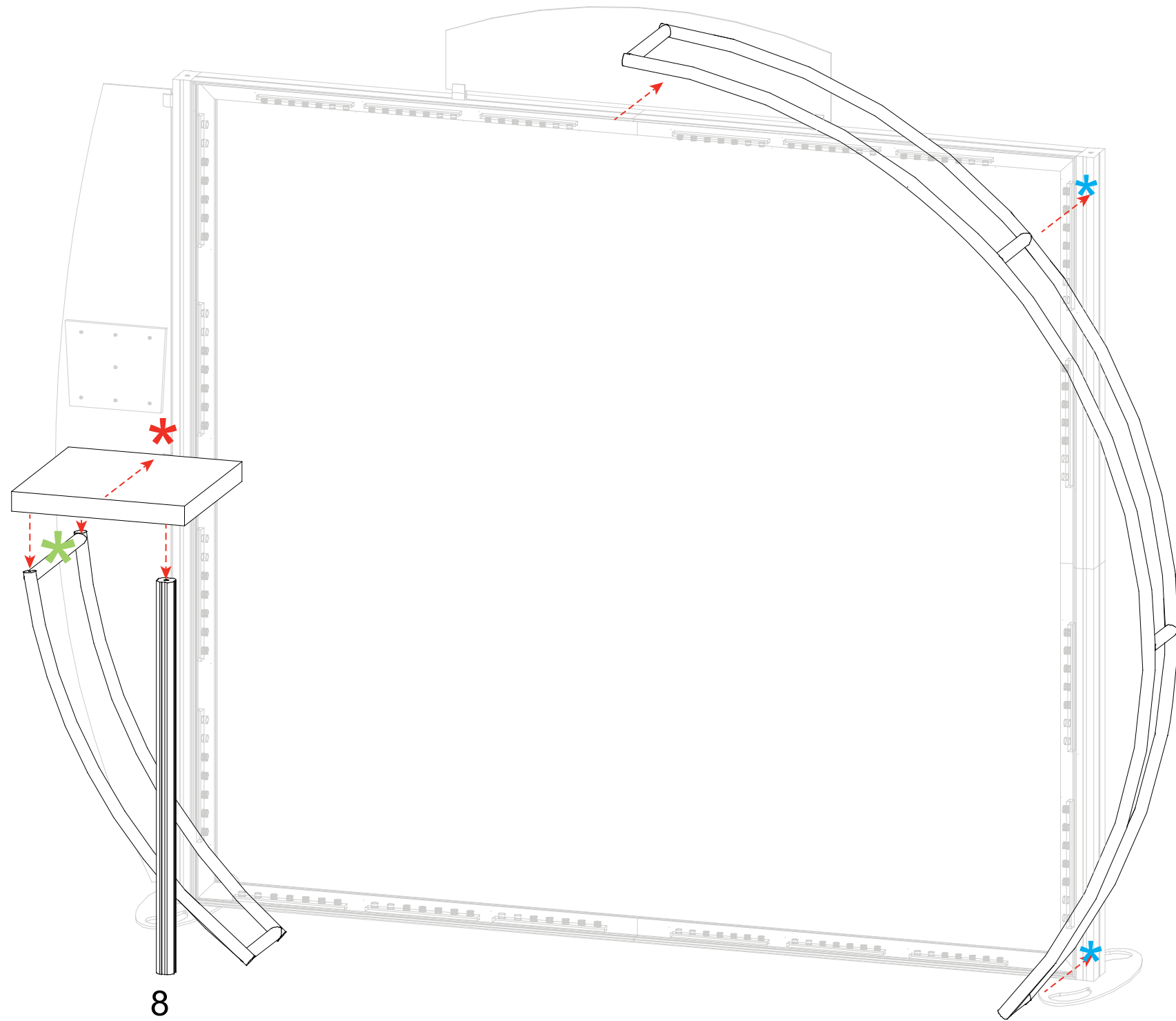

When assembled

Step 4

* Shelf Attachment

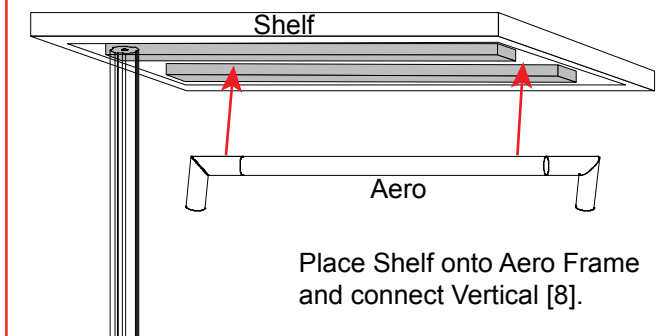

Place Shelf onto Aero Frame and connect Vertical [8].

* Shelf Attachment

Insert lock into groove of vertical extrusion and tighten setscrew.

Setscrew will face outward for ease of assembly

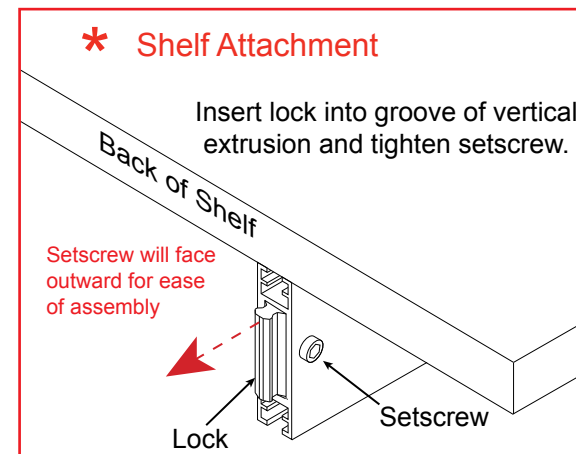

* Keyhole Attachment

